

Quick Installation Guide

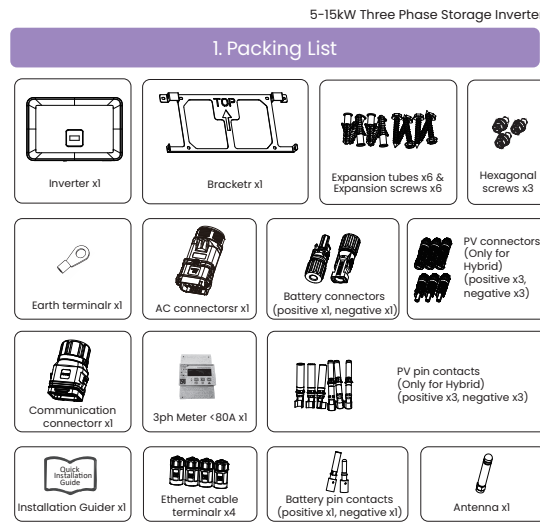

2. Mounting Steps

Step 1: Please make sure the inverter will be installed with a proper distance as shown below.

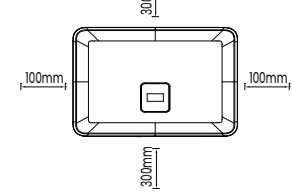

9. RJ45 connection

The machine has three RJ45 terminals, which are meter, Ethernet, and DRM functions.

The definition of meter port pin is as follows:

PIN	1	2	3	4	5	6	7	8
Port	meter 485A	meter 485B	/	/	/	/	meter 485B	meter 485A

The definition of Ethernet port pin is as follows:

PIN	1	2	3	4	5	6	7	8
Port	Ethernet Tx+	Tx-	Rx+	/	/	/	Rx-	/

The definition of DRM port pin is as follows:

PIN	1	2	3	4	5	6	7	8
Port	DRM +3.3V	DRM1	DRM2	DRM3	DRM4	DRM5	GND	GND

APP Configuration

Step 1: Open the APP, click 'Local Distribution Network' on the login page.

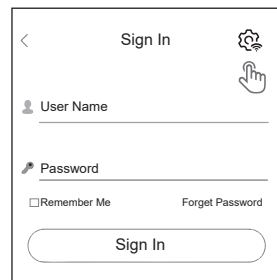

Then click 'Wifi Config'.

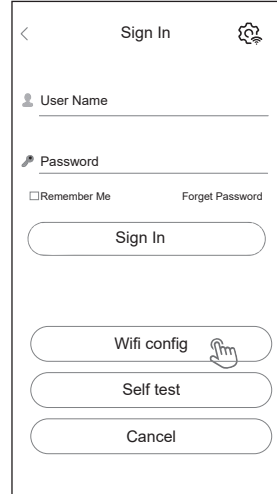

Step 2: Select the installation location, place the bracket on the wall, and mark the hole positions.

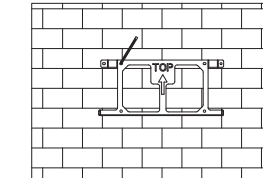

Step 2: Drill the 8 holes with a φ8 drill bit. Depth: at least 50mm. Hammer the expansion tubes.

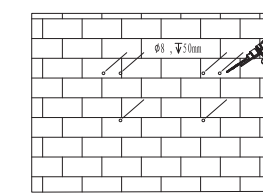

Step 5: Match the inverter with wall bracket.

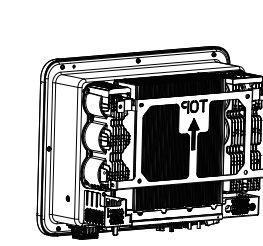

Step 4: Installing the Bracket. Screw the expansion bolts.

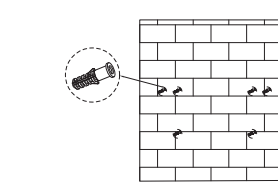

Step 6: Lock the screws on the side (left and right). Make sure the inverter is firmly attached.

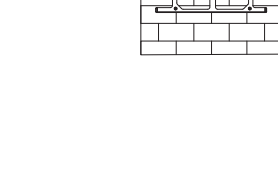

1

RJ45 Wiring

Installation Procedure of the RJ45 Connector

Step 1: Insert the network cable into the wire-locking nut, sealing plug and mainbody in turn. The sealing plug is stuck into the network cable through the gap on the sealing side.

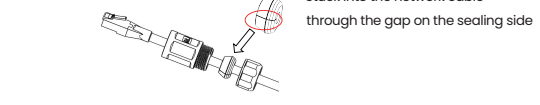

Step 2: Insert the network cable plug into the matched RJ45 panel mount connector.

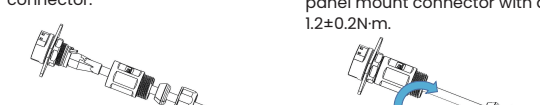

Step 4: Insert the sealing plug into the main body of RJ45 cable end connector.



2

Or sign in app, click on the 'me' page. Then click 'Wifi Config'.

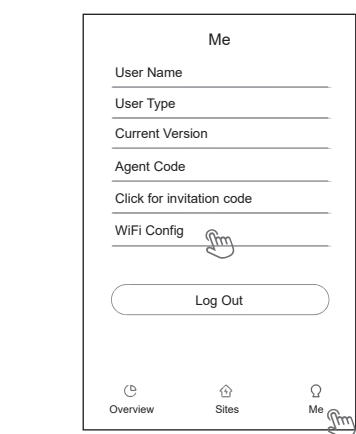

Step 2: Please scan the 'SN' on the collector.

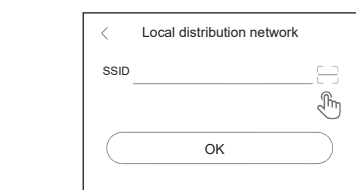

Step 3: Connect your mobile device with Smart WiFi. The SSID of the Smart WiFi is 'W-xxxxx' and the password is 'mim2020'.

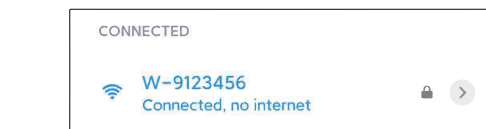

1

3. GRID Connection

Step 1: Prepare AC wire. Cable is a five-core cable with a diameter less than 9-16 mm. Cross-sectional area of wire is shown in the following table.

Model (kW)	5.0	6.0	8.0	10.0	12.0	15.0
Cable (GRID)	4.0mm²	4.0mm²	6.0mm²	6.0mm²	6.0mm²	6.0mm²
Cable (EPS)	4.0mm²	4.0mm²	6.0mm²	6.0mm²	6.0mm²	6.0mm²
Micro-Breaker	20A	20A	25A	25A	32A	32A

Step 2: Dimension of stripping line

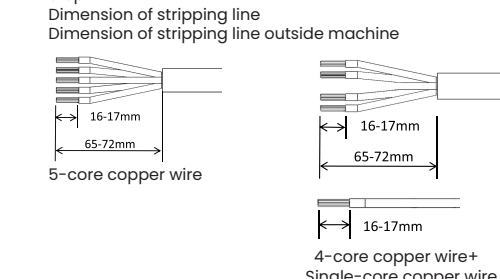

Step 3: Wiring Precautions

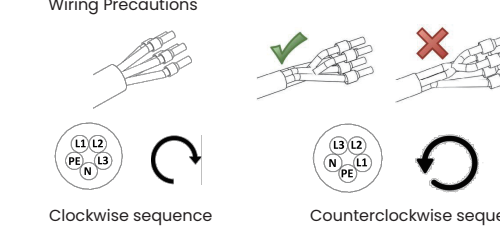

Step 4: Seal accessory option

A. Ø16: The recommended outer diameter of the cable is 17.5-18.5mm.
B. Ø21: The recommended outer diameter of the cable is 19-21mm.
C. Ø6: When the four wire system is used, the special hole for the ground wire is recommended to be applicable to the outer diameter of the cable. (5-6mm)

CT-Meter Type

Step 1: Insert U/I2/3/N wires, CT and RS485A/B cable into the meter. Please refer to the meter wiring diagram on side of meter itself. During CT use, the direction of the CT arrow faces the inverter.

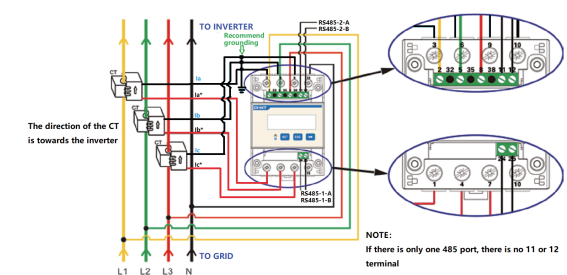
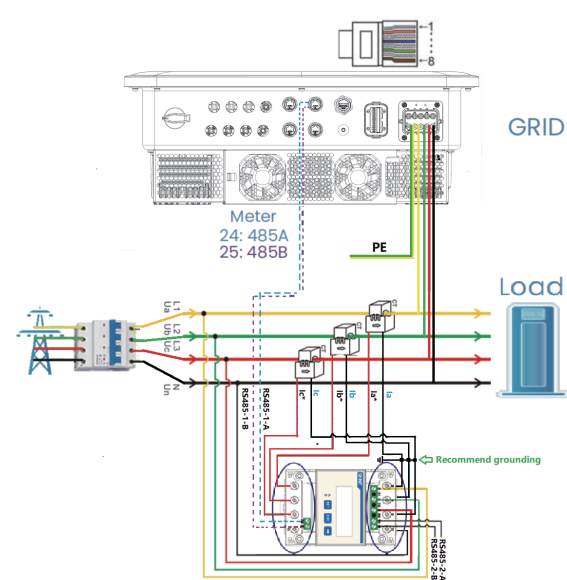

3

Please scan the QR Code and follow the steps below to download our latest multi-language User Manual/Quick Installation Guide.

Scan the QR Code -> Select your Language -> Choose to download User Manual or Quick Installation Guide -> Download



2

4. EPS Connection

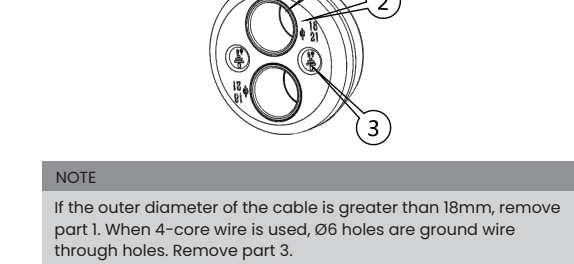

NOTE: If the outer diameter of the cable is greater than 18mm, remove part 1. When 4-core wire is used, Ø6 holes are ground wire through holes. Remove part 3.

Installation steps for 5-core wire: Thread the stripped wire into the lock nut and the main body in turn. (the flexible wire needs to be riveted to the insulated terminal)

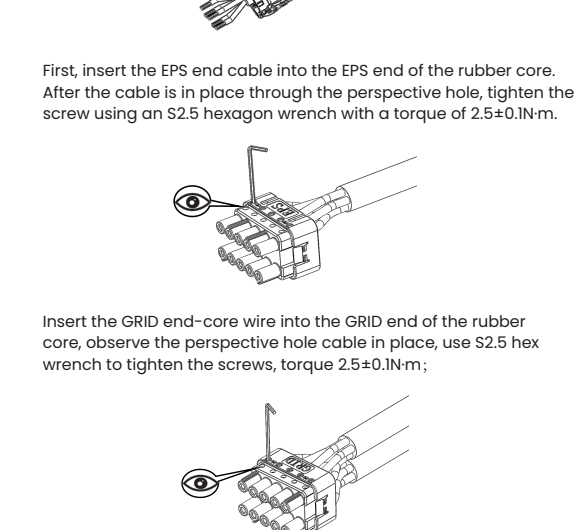

4

5. EPS Connection

Step 1: Prepare AC wire. Cable is a five-core cable with a diameter less than 9-16 mm. Cross-sectional area of wire is shown in the following table.

Model (kW)	5.0	6.0	8.0	10.0	12.0	15.0
Cable (GRID)	4.0mm²	4.0mm²	6.0mm²	6.0mm²	6.0mm²	6.0mm²
Cable (EPS)	4.0mm²	4.0mm²	6.0mm²	6.0mm²	6.0mm²	6.0mm²
Micro-Breaker	20A	20A	25A	25A	32A	32A

Step 2: Dimension of stripping line

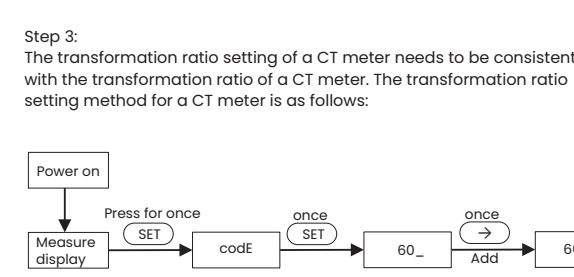

Step 3: Wiring Precautions

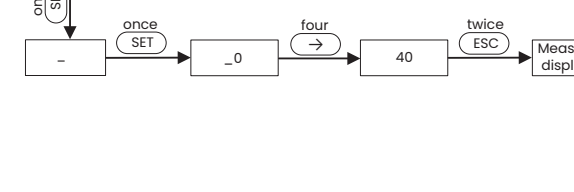

Step 4: Seal accessory option

A. Ø16: The recommended outer diameter of the cable is 17.5-18.5mm.
B. Ø21: The recommended outer diameter of the cable is 19-21mm.
C. Ø6: When the four wire system is used, the special hole for the ground wire is recommended to be applicable to the outer diameter of the cable. (5-6mm)

5

6. EPS Connection



NOTE: If the outer diameter of the cable is greater than 18mm, remove part 1. When 4-core wire is used, Ø6 holes are ground wire through holes. Remove part 3.

Installation steps for 5-core wire: Thread the stripped wire into the lock nut and the main body in turn. (the flexible wire needs to be riveted to the insulated terminal)



4

7. Grounding connection

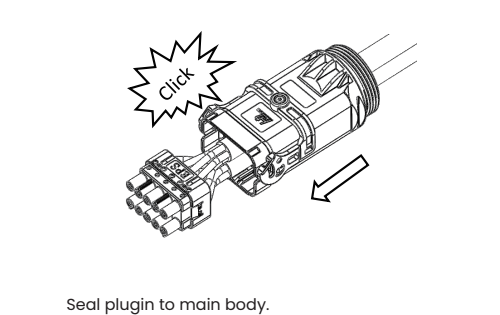

NOTE: If the outer diameter of the cable is greater than 18mm, remove part 1. When 4-core wire is used, Ø6 holes are ground wire through holes. Remove part 3.

Installation steps for 5-core wire: Thread the stripped wire into the lock nut and the main body in turn. (the flexible wire needs to be riveted to the insulated terminal)

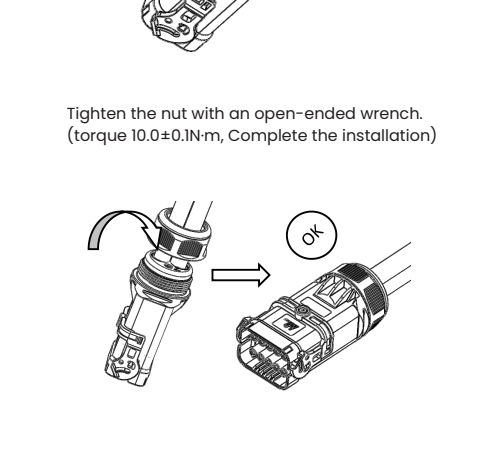

6

8. Firmware Update

Preparation: Please ensure the inverter is powered on with steady PV/BAT and AC power. Please prepare a PC and an U-Disk. Please note the U-Disk should be less than 32GB and its format is fat16 or fat 32. Please DO NOT apply USB2.0 U-Disk on USB port, the inverter USB port only support for USB2.0 U-disk.

Step 1: Connect your mobile device with Smart WiFi. The SSID of the Smart WiFi is 'W-xxxxx' and the password is 'mim2020'.

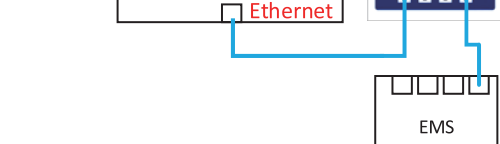

Step 2: The LCD will show the selection menu. Then press up and down to select the one that you want to upgrade and press 'OK' to confirm to upgrade.

Step 3: After the upgrade is finished, pull out the U-disk. Screw the waterproof lid.

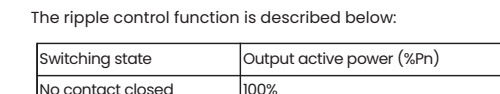

Step 4: After connecting successfully, open browser and enter 192.168.1.1 on the address bar on top.

Step 5: Drop down the WiFi SSID menu to find house router and input the house router's password. Click 'Save'.



Step 6: The LCD will show the selection menu. Then press up and down to select the one that you want to upgrade and press 'OK' to confirm to upgrade.

Step 7: After the upgrade is finished, pull out the U-disk. Screw the waterproof lid.



Step 8: The LCD will show the selection menu. Then press up and down to select the one that you want to upgrade and press 'OK' to confirm to upgrade.

Step 9: After the upgrade is finished, pull out the U-disk. Screw the waterproof lid.



Step 10: The LCD will show the selection menu. Then press up and down to select the one that you want to upgrade and press 'OK' to confirm to upgrade.

Step 11: After the upgrade is finished, pull out the U-disk. Screw the waterproof lid.



Step 12: The LCD will show the selection menu. Then press up and down to select the one that you want to upgrade and press 'OK' to confirm to upgrade.

Step 13: After the upgrade is finished, pull out the U-disk. Screw the waterproof lid.

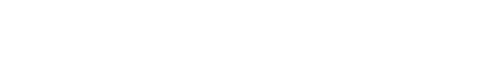

Step 14: The LCD will show the selection menu. Then press up and down to select the one that you want to upgrade and press 'OK' to confirm to upgrade.

Step 15: After the upgrade is finished, pull out the U-disk. Screw the waterproof lid.



Step 16: The LCD will show the selection menu. Then press up and down to select the one that you want to upgrade and press 'OK' to confirm to upgrade.

Step 17: After the upgrade is finished, pull out the U-disk. Screw the waterproof lid.

7

4. EPS Connection

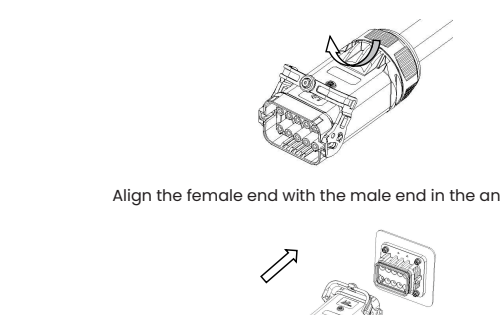

NOTE: If the outer diameter of the cable is greater than 18mm, remove part 1. When 4-core wire is used, Ø6 holes are ground wire through holes. Remove part 3.

Installation steps for 5-core wire: Thread the stripped wire into the lock nut and the main body in turn. (the flexible wire needs to be riveted to the insulated terminal)

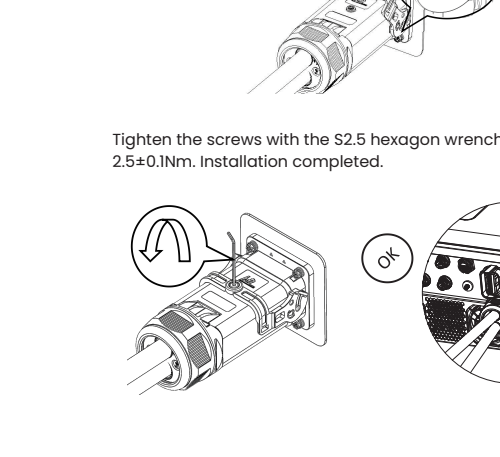

8

10. COM connection

Introduction to COM port:

The COM port mainly includes EMS485, Meter485, WiFi485, Estop port, two relay output ports, two parallel ports and a toggle switch, +12V and corresponding relay output signals.

The ripple control function is described below:

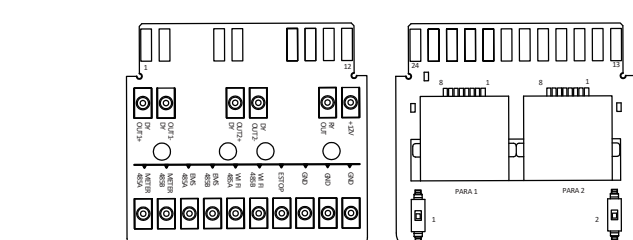

EMS 485:

Supports Modbus485 communication, which can be used to read and control machines. The specific protocol is provided by the manufacturer.

Meter 485:

For internal testing. The specific protocol is provided by the manufacturer.

Estop port:

When short circuiting ESTOP and GND, the machine will stop working.

DY OUT:

The machine has two DY OUT interfaces, with two internal contacts of relays hat can drive loads of 230VAC/50VDC0.5A, and can be used for powering on and starting heat pumps.

PARA port RJ45:

Used for parallel communication. It is necessary to set the DIP switch to the ON state during parallel operation. +12V and RY-Out are used to control external relay switches and cannot be used for other functions.

9

11. Inverter Start-Up



Please refer to the following steps to start up the inverter.

1. Ensure the inverter fixed well.

2. Make sure GRID and EPS wirings are completed.

3. Make sure the PV wirings is connected well.

4. Make sure the meter is connected well.

5. Make sure the battery is connected well.

6. Make sure the BMS buttons and battery switch are on.

7. Ensure accurate installation of the monitoring module to the inverter. (Refer to the installation of the monitoring module)

8. Turn on the PV/DC switch (for Hybrid version only), AC breaker, EPS breaker and battery breaker.

9. Check whether each voltage is normal and within the operating range of the machine through the screen on the machine.

10. If the main page shows 'switch off', please long press 'V' bottom to quickly go to the START/STOP page and set it to start. (Enter the settings page, default password is '0000').

10

4. EPS Connection

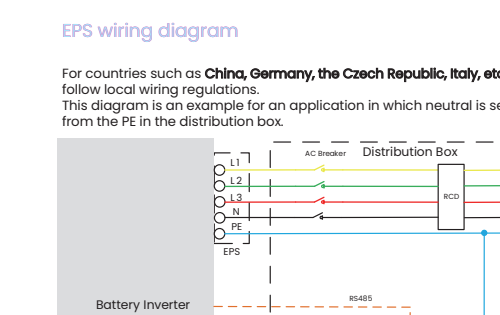

NOTE: If the outer diameter of the cable is greater than 18mm, remove part 1. When 4-core wire is used, Ø6 holes are ground wire through holes. Remove part 3.

Installation steps for 5-core wire: Thread the stripped wire into the lock nut and the main body in turn. (the flexible wire needs to be riveted to the insulated terminal)

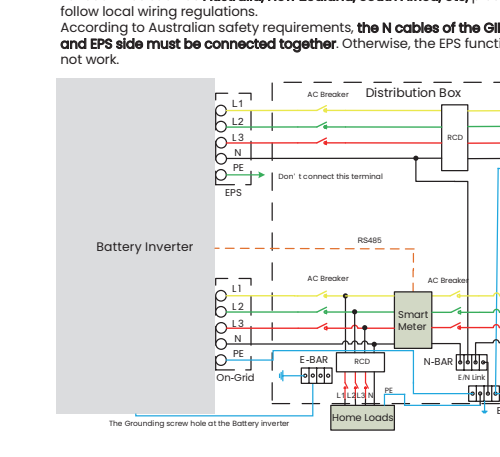

11

24PIN Wiring

Installation Procedure

Step 1: Remove the plug inside the plug and thread the terminal according to the sequence shown in the illustration.

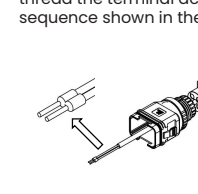

Step 2: Insert the wires into the corresponding terminals.

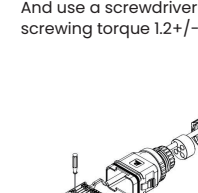

Step 3: And use a screwdriver to crimp the wire, screwing torque 12+/-0.1N.m.

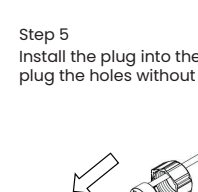

Step 4: Arrange the core line, the rubber core areamust not appear to ride the line. The rubber core is loaded into the main body and accompanied by a 'click' sound.



Step 5: Install the plug into the main body and plug the holes without wires with a plug.

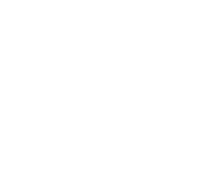

Step 6: Lock wire nut screwed onto the body, torque 25+/-0.1N-m, then complete installation.



NOTE: When starting inverter for the first time, the country code will be set by default to the local settings. Check if the country code is correct. Set the time on the inverter using the button or by using the APP.

When starting inverter for the first time, the country code will be set by default to the local settings. Check if the country code is correct. Set the time on the inverter using the button or by using the APP.

When starting inverter for the first time, the country code will be set by default to the local settings. Check if the country code is correct. Set the time on the inverter using the button or by using the APP.

When starting inverter for the first time, the country code will be set by default to the local settings. Check if the country code is correct. Set the time on the inverter using the button or by using the APP.

When starting inverter for the first time, the country code will be set by default to the local settings. Check if the country code is correct. Set the time on the inverter using the button or by using the APP.

When starting inverter for the first time, the country code will be set by default to the local settings. Check if the country code is correct. Set the time on the inverter using the button or by using the APP.

When starting inverter for the first time, the country code will be set by default to the local settings. Check if the country code is correct. Set the time on the inverter using the button or by using the APP.

When starting inverter for the first time, the country code will be set by default to the local settings. Check if the country code is correct. Set the time on the inverter using the button or by using the APP.

When starting inverter for the first time, the country code will be set by default to the local settings. Check if the country code is correct. Set the time on the inverter using the button or by using the APP.

When starting inverter for the first time, the country code will be set by default to the local settings. Check if the country code is correct. Set the time on the inverter using the button or by using the APP.

When starting inverter for the first time, the country code will be set by default to the local settings. Check if the country code is correct. Set the time on the inverter using the button or by using the APP.

When starting inverter for the first time, the country code will be set by default to the local settings. Check if the country code is correct. Set the time on the inverter using the button or by using the APP.

When starting inverter for the first time, the country code will be set by default to the local settings. Check if the country code is correct. Set the time on the inverter using the button or by using the APP.

When starting inverter for the first time, the country code will be set by default to the local settings. Check if the country code is correct. Set the time on the inverter using the button or by using the APP.

When starting inverter for the first time, the country code will be set by default to the local settings. Check if the country code is correct. Set the time on the inverter using the button or by using the APP.

When starting inverter for the first time, the country code will be set by default to the local settings. Check if the country code is correct. Set the time on the inverter using the button or by using the APP.

When starting inverter for the first time, the country code will be set by default to the local settings. Check if the country code is correct. Set the time on the inverter using the button or by using the APP.

When starting inverter for the first time, the country code will be set by default to the local settings. Check if the country code is correct. Set the time on the inverter using the button or by using the APP.

When starting inverter for the first time, the country code will be set by default to the local settings. Check if the country code is correct. Set the time on the inverter using the button or by using the APP.

When starting inverter for the first time, the country code will be set by default to the local settings. Check if the country code is correct. Set the time on the inverter using the button or by using the APP.

When starting inverter for the first time, the country code will be set by default to the local settings. Check if the country code is correct. Set the time on the inverter using the button or by using the APP.

11

5. PV connection

PV Wiring (For Hybrid Only)

Step 1: Prepare PV wire. Choose 12 AWG wire to connect the PV module. Trim 6mm of insulation from the wire end.

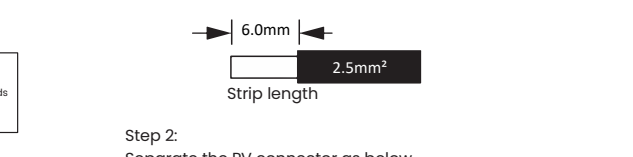

Step 2: Separate the PV connector as below.

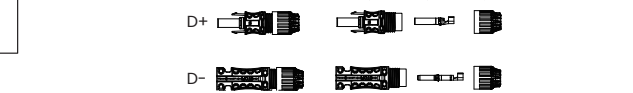

Step 3: To insert terminal. Press the wire and terminal tightly with a wire clamp. Rivet terminal. Ensure the concave-convexity of metal parts and cable at same level/crimped metal parts and cable pull tension 230N.

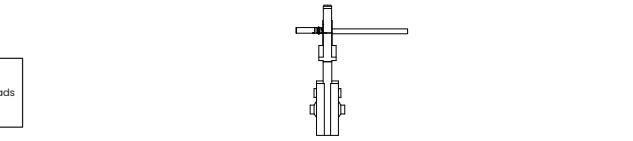

Step 4: Insert pin into the male or female plug. Until hear a "